

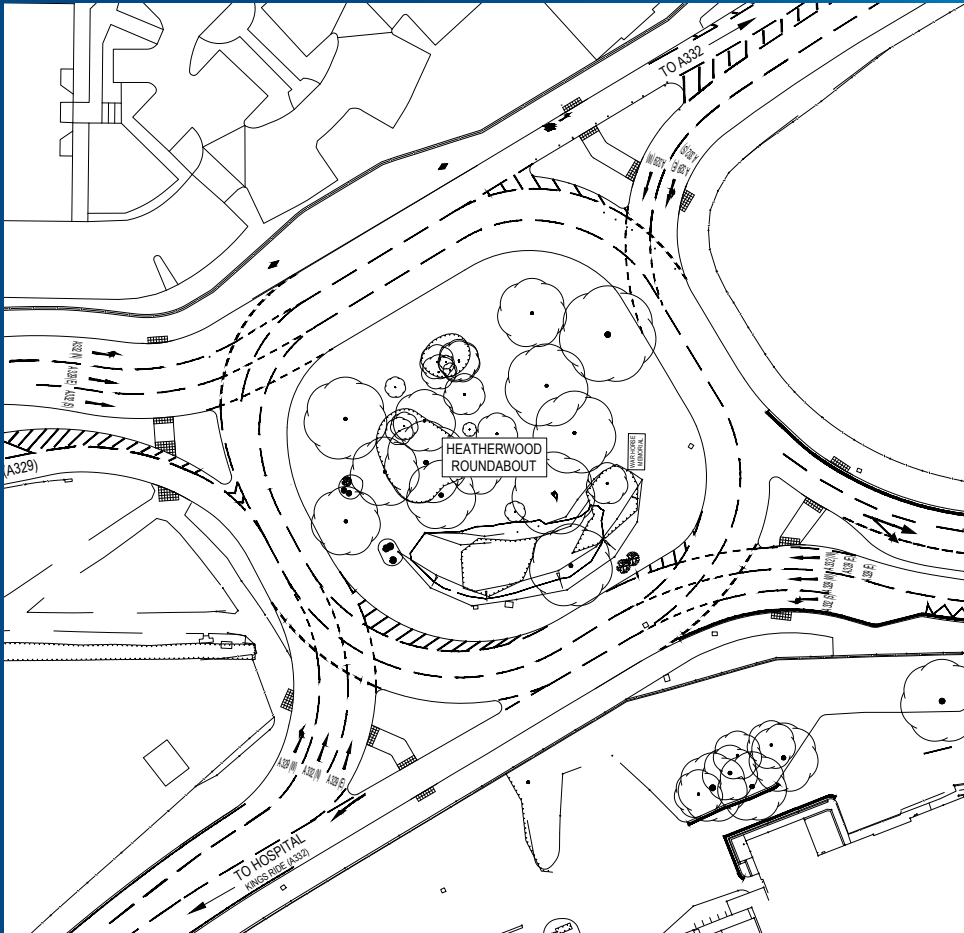

Frimley Health  
NHS Foundation Trust



If you have any questions, concerns, or comments about the roadworks, please contact:

Syed Shah MBA MCIPR | Public Liaison Officer  
Email: [s.shah@jmccann.co.uk](mailto:s.shah@jmccann.co.uk) or phone: 07399 799604

For more information about the Heatherwood Hospital development visit our website: [www.fhft.nhs.uk](http://www.fhft.nhs.uk)

Our workforce abide by strict social distancing rules set out by the Government site operating procedures. Please respect them in return.

# On the road to our new Heatherwood Hospital



## What's happening, where and when?

### Closures to main Heatherwood roundabout

Over the next two weeks there will be a number of overnight and single-day road closures on and around the main Heatherwood roundabout while road planning works, new asphalt and line painting are completed.

#### Western half of roundabout

*(including approaches)*

**4 August:** 9:00 am – 3:00 pm

**5 – 6 August:** 8:00 pm – 5:00 am *(Two nights)*



#### Eastern half of roundabout

*(including approaches)*

**9 August:** 9:00 am – 3:00 pm

**10 – 11 August:** 8:00 pm – 5:00 am *(Two nights)*



Gate 2 at Heatherwood Hospital will remain open throughout the roadworks and entry for patients and staff will be clearly signposted.

In order to minimise traffic disruption and in accordance with RBWM council requirements, these works are being undertaken on nights and off-peak days. Diversion routes can be found by scanning the above QR codes or visiting <https://one.network>

**Site Safety: You may experience delays for safety reasons. Please be patient with site and traffic management staff**

## Why are we doing this?

The work by McCann will result in an increase from two to three lanes with dedicated filter lanes, which should assist in traffic flow and allow better access to the new hospital. There will also be improved street lighting, signage and pedestrian access, including upgraded pedestrian crossing areas.

This brings us a step closer to completion of the new hospital which will specialise in planned, non-emergency operations, diagnostics and outpatients. The new Heatherwood Hospital will provide us with a dedicated, state-of-the-art facility using the latest technology to deliver outstanding services.

Due to its location in the heart of our community it will meet the needs of our NHS and private patients across Berkshire, Hampshire and Surrey.

Our new hospital will have six operating theatres, 48 inpatient beds and 22 day-case cubicles and provide operations, diagnostics and outpatient care to both NHS and private patients.

## What it means for you:

- Investment in your NHS to meet future increased demand
- Care and support in state-of-the-art theatres, wards and clinics
- Cutting edge technology for NHS and private patients
- Increased access to diagnostic facilities
- Greater efficiency and value for money in a sustainable building environment.